

# HANDYWASH

Installation Manual  
**SEHW3KM1, SEHW3KA1**

Issue 1 2017

SEHW3KA1 Model Shown

**STROM-**  
**LIMITED**  
*www.stromltd.com*

## INTRODUCTION

Thank you for purchasing your **Strom Limited** instantaneous water heater, we are very proud of our products and we are sure that you will be happy with the years of service you get from your model. This product has been designed to operate at mains pressure and deliver instant hot water.

## SPECIFICATION

MODEL	SEHW3KM1	SEHW3KA1
Body Material	High Strength ABS Plastic	
Spout Material	High Quality Stainless Steel	
Voltage	220-240v	
Rated Frequency	50-60Hz	
Power	3.0kW	
Rated Current	13A	
Recommended Cable Size	1.5mm <sup>2</sup>	
Thermal Cut-Out	65°C	
Dry Heating Protection	70°C	
Hot Water Flow	0.5L - 2L Per Minute (Dependent On Required Temp)	
IP Rating	IPX4	
Working Pressure	0.2 - 6 Bar	
Sensing Distance	N/A	50mm

## IMPORTANT NOTICE

- For your satisfaction and safety, read all instructions before installing or using this instant hot water heater.
- This particular unit is not intended for commercial use.
- This appliance should be connected to mains water feed.
- This water heater may not be suitable for unsupervised use by children, the elderly, or persons of diminished responsibility due to the risk of scalding should the flow of water not be controlled properly.

- Your **Strom Limited** water heater **MUST** be installed and maintained regularly by a qualified professional in accordance with current electrical and plumbing regulations.
- If the chloride content exceeds 200ppm a filtration system should be fitted, failure to do so may invalidate your warranty.
- This device has been designed for internal use only, if the system may be exposed to frost please drain down the system completely, and **DO NOT** attempt to use the device if you suspect it is frozen.
- Always ensure that the flow temperature is not excessive before use. If the water is too hot please increase the flow rate and wait for the temperature to reduce.
- As part of the product maintenance regularly clean the filter washer provided, failure to do so may reduce your flow rate over time.
- The HandyWash is not designed for modification in any way, please do not fit anything to the unit unless otherwise recommended.
- When commissioning the water valve should be adjusted to increase or decrease the water flow to the unit, this in turn will control the temperature of water from the outlet, slower increases the temperature, faster decreases the temperature.
- Each unit is tested at our factory before its departure, a little residual water is normal, and the product should be flushed through before use.
- Never try to operate this device if your water supply is blocked or turned off, doing so could cause premature failure of your device.
- Any damage to the wiring or integrity of your device should be assessed by a qualified electrician, and the device should not be used until the unit or wiring has been repaired.
- The minimum water supply available at the point of install is 0.2 Bar.
- If at any time the water heater begins to overheat or produce water too hot for use and increasing the flow doesn't cure the problem please isolate the electrical supply and consult your installer or our technical team immediately.

## BEFORE INSTALLATION

This installation must only be performed by a qualified electrician and installed to all relevant national and local electrical and plumbing regulations. Failure to do this could render the install both illegal and dangerous. Before installation please ensure the following:

1. Your **Strom Limited** appliance is intact, and the fittings are supplied & complete.
2. Please make sure the mains power supply, water pressure, earthing condition, and cabling reach the standards required for installation as required by all relevant regulations & laws.
3. The appliance must be properly earthed in accordance with all current regulations and laws.
4. If the unit is not to be used for a prolonged period of time please drain down and isolate the electrical supply of the product.
5. Position the unit upright with all plumbing connections at the bottom of the unit.
6. During the installation please test water flow is achieved at the tap before connecting the power supply. If the heater is activated without water supply the unit may be damaged.
7. Check incoming mains water pressure, if greater than 6 bar please reduce the pressure with a pressure reducing set available from your merchant. Failure to do so may damage your device & render your device warranty void.

# PRODUCT STRUCTURE

## SEHW3KM1

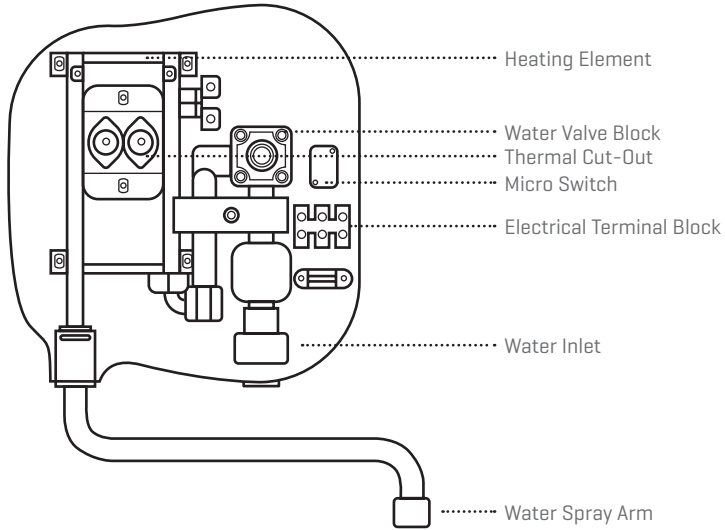

## SEHW3KA1

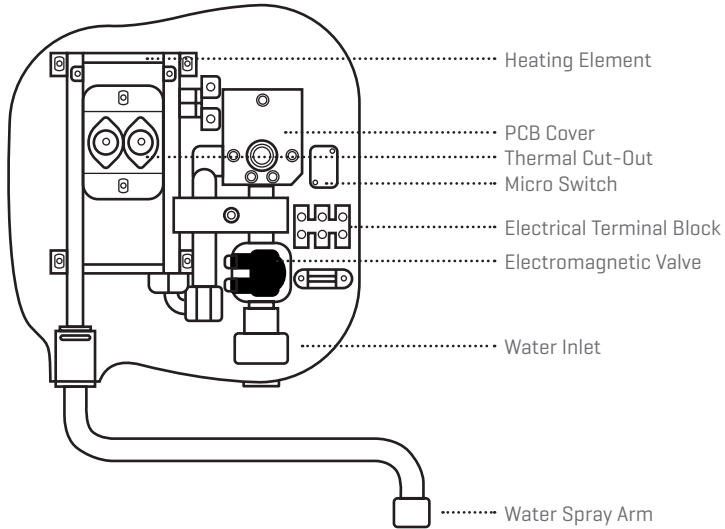

## WIRING SCHEMATIC

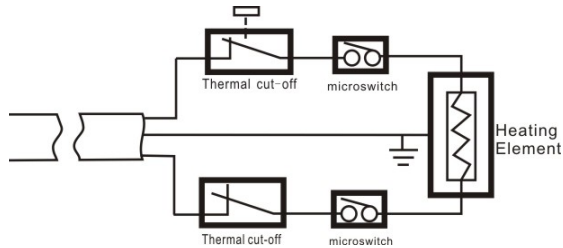

- This diagram is provided for your reference of the internal wiring of your **Strom Limited** water heating product.
- No attempt should be made to change the internals of your water heater, doing so may be dangerous and will invalidate your warranty.
- Your product **MUST** always be wired by a qualified electrician in accordance with all the relevant regulations and laws in place at the time of installation.

## INSTALLATION

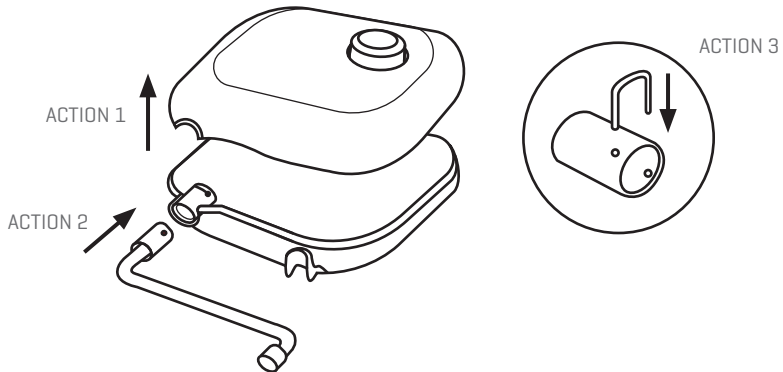

1. To connect the Sprayer Spout, start by ensuring the temperature control dial is set in the off position. Remove the two screws at the base of the unit and then remove the front cover of the unit [ACTION 1]. Push the end of the water outlet sprayer firmly into the outlet out of the heating element and ensure it is all the way in [ACTION 2]. Push the plastic sleeve as high up as it can go then insert the circlip into the two holes of the plastic sleeve [ACTION 3]. Ensure the water outlet sprayer is firmly installed.

2. Using the template provided work out where best to secure this unit on to the wall ensuring that it is level. Mark up the drill holes through the holes in the template then drill through and place wall plugs into the holes. Offering your unit up to the wall and screw into the corresponding holes on the unit to the holes on the wall and ensure the unit is secure on the wall.
3. We suggest fitting an isolation valve or ball valve before the tap to facilitate removal of the unit and servicing. Connect your cold mains supply to the internal ½" thread's making sure that the flow reducing washer provided is fitted the correct way around between the nut and threads.
4. Make the correct electrical connections to the unit, but do not turn the power back on at this stage. A minimum heat resistance cable size of 1.5mm<sup>2</sup> should be used. The product can be connected in two different ways:
  - Via a fused and switched connection unit taken as a spur from a 13amp ring main.
  - As a separate circuit taken directly from a spareway in a consumer unit.In each case a double pole isolating switch having a contact separation of at least 3mm in each pole, and a minimum rating of 13amp must be incorporated in the wiring of the appliance.
5. Before replacing the front cover of the unit make sure that there are no leaks from the cold inlet connection. Place the front cover back on to the unit whilst still ensuring the temperature control dial is still in the off position. Finally replace the screws at the base of the unit.

**REMEMBER:** Before turning off the water supply to the unit you must isolate its electric supply, operating the tap while there is no water can cause premature failure and invalidate your warranty. **DO NOT** turn on your electric supply at this time.

## COMMISSIONING

1. Flush the unit completely for 20 seconds, to do this turn the control dial to the fully open cold position, in the case of the automatic model please restore power to the unit only when the control dial is in the fully cold position.
2. Once flushed for 20 seconds please move the control dial to the off position and in the case of the manual model please also restore power.
3. To set the flowrate and temperature of the unit please set the control dial to the midway position on the hot side.
4. Whilst in this position please restrict water flow to the unit using the isolating valve fitted before the unit. Restricting the flow will increase the output temperature, whilst increasing the flow will decrease the temperature.
5. Once the required temperature is achieved please set control dials on manual models to the off position, and set automatic models to the correct temperature ready for use.
6. Your HandyWash is now ready for use.

## GENERAL USE

### SEHW3KM1

- Turning the temperature dial towards cold will give you cold water, the further towards cold you turn the temperature dial the faster the cold water will come out of the tap.
- Turning the temperature dial towards hot will give you hot water, the further towards hot you turn the temperature dial the faster hot water will come out of the tap however, the higher the flow rate the cooler the water will be. By pushing the control only slightly towards hot the flow rate will be very low but the water temperature will be very hot. **REMEMBER:** This product, if used incorrectly can scald, if the water is too hot increase the flow rate by turning the temperature dial further forwards, if it is too cool reduce the flow rate by throttling the temperature dial backwards.
- Leaving the temperature dial in the central OFF position turns the flow rate and the heater off. **REMEMBER:** If you are to leave this product unattended for long periods of inactivity please isolate the electric supply, and drain the product down. After a draindown please follow the commissioning procedure again.

### SEHW3KA1

- Turning the temperature dial towards cold will give you cold water, the further towards cold you turn the temperature dial the faster the cold water will come out of the tap.
- Turning the temperature dial towards hot will give you hot water, the further towards hot you turn the temperature dial the faster hot water will come out of the tap however, the higher the flow rate the cooler the water will be. By pushing the control only slightly towards hot the flow rate will be very low but the water temperature will be very hot. **REMEMBER:** This product, if used incorrectly can scald, if the water is too hot increase the flow rate by turning the temperature dial further forwards, if it is too cool reduce the flow rate by throttling the temperature dial backwards.
- To activate the flow of water from the unit simply pass your hand in front of the control dial, your hand should pass within 5cm of the device in order to activate the flow.
- Leaving the temperature dial in the central OFF position turns the flow rate and the heater off. **REMEMBER:** If you are to leave this product unattended for long periods of inactivity please isolate the electric supply, and drain the product down. After a draindown please follow the commissioning procedure again.

## MAINTENANCE

### Always turn off the power supply before servicing your unit

To ensure a long lasting and efficient product we recommend the following maintenance regime:

- Periodically remove scale and dirt that may build up at the aerator of the faucet or in the sprinkler.
- The filter washer supplied and fitted should be cleaned to reduce any debris build up and ensure good consistent flow rates.

## TROUBLESHOOTING

SYSTEM ISSUE	LIKELY CAUSE	POSSIBLE SOLUTION
No Hot Water Is Supplied When The Tap Is Turned On.	Inlet flow rate is less than 0.4L/Min	Increase the inlet flow rate
	There is no power supply	Please call an electrician to inspect your installation
Outlet Temperature Is Too Hot	Flow rate is too low	Increase the flow rate at the unit
Outlet Temperature Is Too Cold	Flow rate is too high	Reduce the flow rate at the tap
Flow Rate At The Tap Is Low	Filter washer clogged	Please clean the filter washer
Water Flow At The Tap Is Uneven Or Spraying	Sprinkler at the tap is blocked or impeded	Remove limescale from sprinkler and clean.

## GUARANTEE

Your **Strom Limited** water heater is guaranteed for a period of 12 months from the date of purchase. The unit is only guaranteed if the water heater has been installed and maintained in accordance with these instructions. Full guarantee information can be found at: [www.stromltd.com/guarantee](http://www.stromltd.com/guarantee)

The guarantee specifically excludes:

- Corrosion by incorrect maintenance of the water heater, or incorrect installation.
- Limescale build up.
- Consequential losses, including labour charges and damages to fittings.
- Any water heater that has not been maintained and installed in accordance with this manual.
- Products not installed by a qualified electrician in accordance with this manual.

## TECHNICAL SUPPORT

For technical support regarding your water heating product please ensure that you have:

- **GOT YOUR PRODUCT SERIAL NUMBER.**
- **HAVE SET THE CORRECT FLOW RATE FOR YOUR UNIT.**
- **HAVE YOUR ELECTRICAL INSTALLATION CERTIFICATE TO HAND.**

**CALL US ON:**

MON-FRI, 8:30am - 4:30pm

**0333 344 24 27**









[www.stromltd.com](http://www.stromltd.com)

**STROM-  
LIMITED**  
*[www.stromltd.com](http://www.stromltd.com)*