

Instruction Manual of Concealed Cistern (Suit for standing floor toilet)

1. Exploded component view

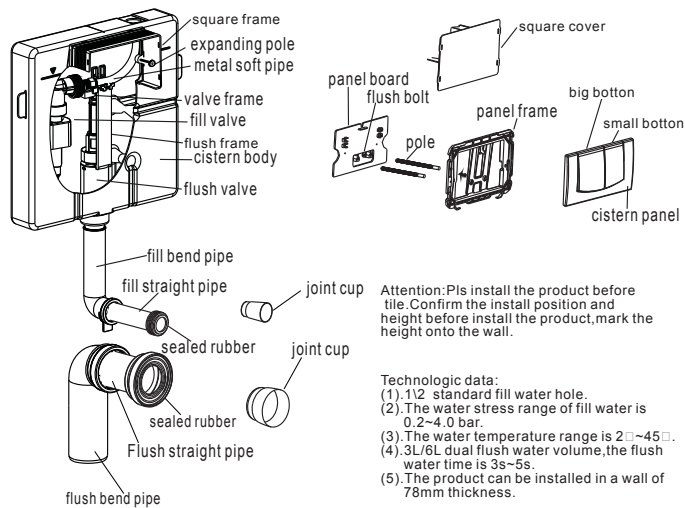

(The product is including all the fittings as shown on the chart)

2. Technologic data:

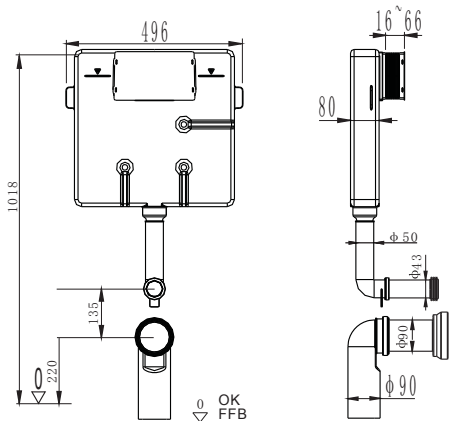

3. Technical requirements for standing floor toilet

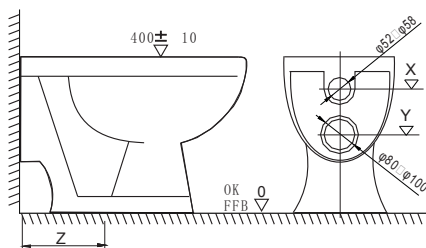

- (1) The diameter of fill hole is $\phi 52\text{mm} \sim \phi 58\text{mm}$
- (2) The outer diameter of flush hole is $\phi 80\text{mm} \sim \phi 100\text{mm}$
- (3) The height from the top surface of standing floor toilet to the floor is 400mm (10mm more or less)
- (4) Measure the height from the centre of fill pipe to the floor X, the height from the centre of flush pipe to the floor Y before install.

4. This cistern is suitable for any of the installations below

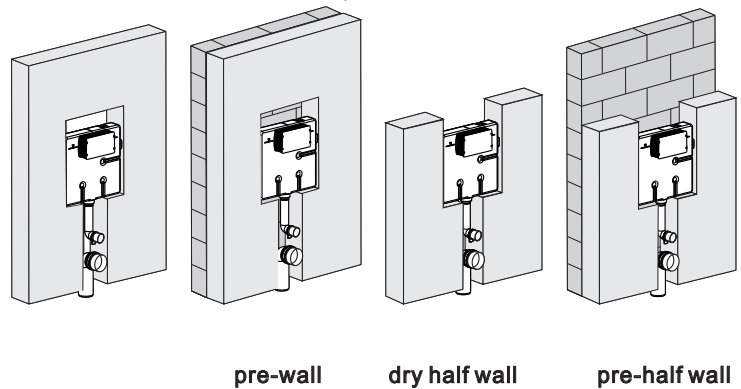

5. Fix the cistern body

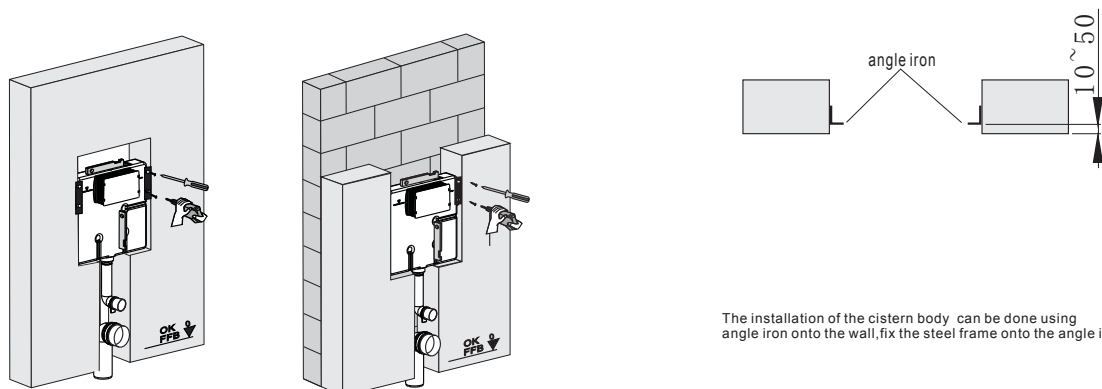

The installation of the cistern body can be done using angle iron onto the wall, fix the steel frame onto the angle iron.

6. Install flush pipe



pipe installed above the floor

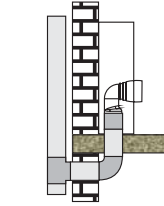

pipe installed under the floor

Fix the position of flush bend pipe according to the height of Y which had measured, turn the flush bend pipe as needed. connect the flush bend pipe with flush straight pipe, fix the flush bend pipe with linker.

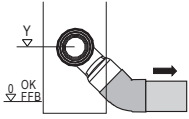

The way of connect the flush bend pipe:
 HDPE plastic: weld the flush bend pipe by heated steel board, connect the flush bend pipe and flush pipeline by rubber tie-in. ABS plastic: smear glue onto the flush bend pipe, connect the flush bend pipe and flush pipeline by rubber tie-in.

7. Install fill water pipe

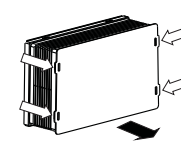

Press the four knot and take out the square cover

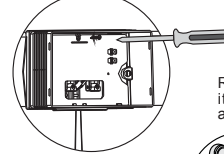

Loosen the screws and remove from the panel board.



Remove the panel board, pull it upward and take it out at an angle.

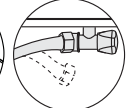
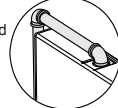

Connect the fill water pipe with angle iron and connect the metal flexible pipe with angle iron

Attention: There may be debris in the new pipe, pls repeat open and close the stop valve several times, flush out the dirt by open & close the water source several times, till appear clean water. At the same time, please wash the dirt from the cistern.

8. Preparative before build wall

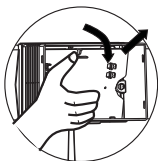

Insert the panel board into the cavity at an angle

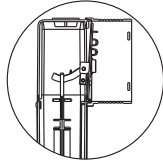

Insert the two hooks of panel board into the flush valve.

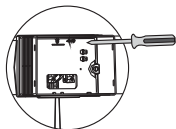

Twist the panel board with screw tightly

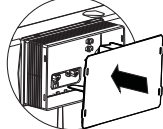

Cover the square cover (to prevent the dirty and prevent the deformation)

9. Build the wall

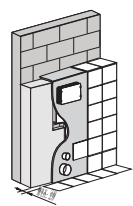

The interval of tile and the square cover no bigger than 5mm

Cover the system of concealed cistern by plasterboard or composite board. Stick tile onto the finished wall. The thickness range of tile onto the finished wall is 20mm~70mm.

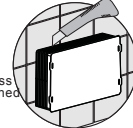

Cut the part which is protruding of tile flat with the wall

10. Install cistern panel

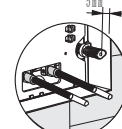

The surface of expanding pole is 5mm lower than the wall surface.

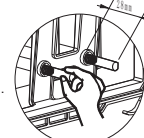

Adjust the outer part of pole to be about 28mm.

valve flush volume too small, maybe is the pole too long; if the flush (if the flush valve can not stop water, the pole is too short)

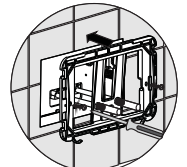

Fix the panel frame onto the expanding pole by screw.

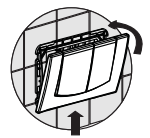

Fasten the bottom of cistern panel onto the panel frame, push the cistern panel upward, close the cistern panel onto the panel frame.

11. Adjust straight pipe

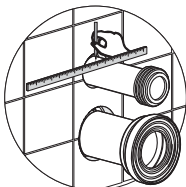

Insert the straight pipe into the bend pipe, make mark on the pipe where is balance to the wall.

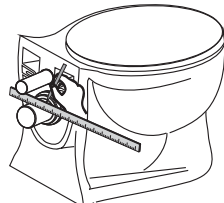

Insert the straight pipe into the hole of standing floor toilet, make mark on the pipe where is balance to the surface of standing floor toilet.

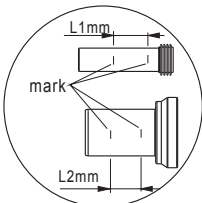

Measure the distance between the two marks.

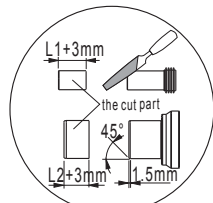

Measure the length of L+3mm at the edge of straight pipe and cut it down. Rub the cut edge of straight pipe by file to remove rough edge.

12. Install standing floor toilet

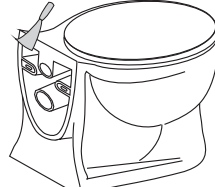

Measure the depth "L" of hanging hole of standing floor toilet, smear small sealant onto the side surface of standing floor toilet where connecting to the wall.

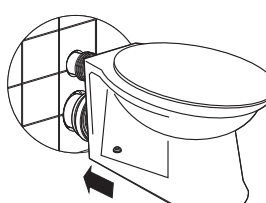

Install the standing floor toilet onto the hanging pole, set decorated ring, gasket, screw & decorated cup onto the hanging pole orderly.

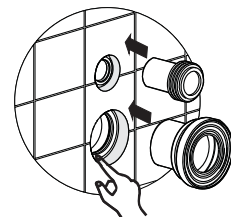

Smear silicon oil onto the sealed rubber of bend pipe equally, insert straight pipe into the bend pipe.



Smear silicone glue onto the side of standing floor toilet where connecting to the wall.

13. Install effect

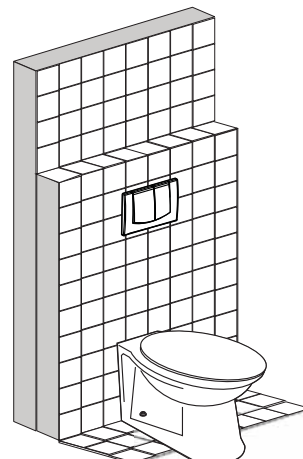
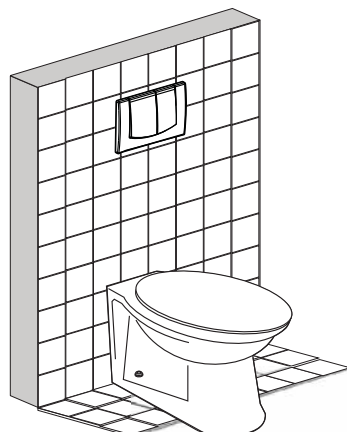

Maintenance Manual of Concealed Cistern (Suit for standing floor toilet)

1、Open cistern panel system

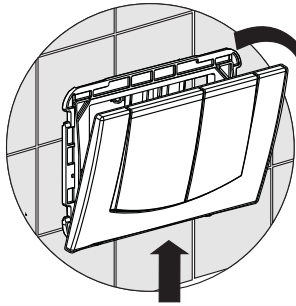

Push the bottom of cistern panel upwards, turn the top of cistern panel about 30°, take the panel out of the panel frame.

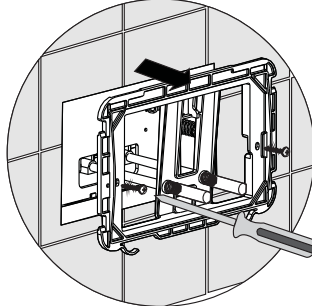

Remove the screw, take out of the panel frame.

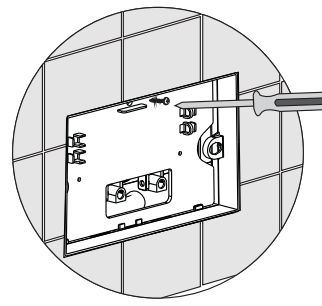

Remove the screws and take off the panel board

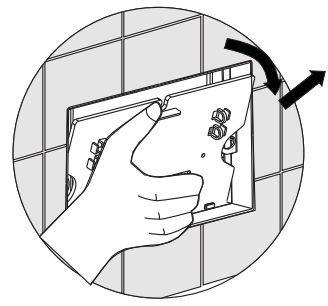

To remove panel board, turn it over about 30° from the top, take it out aslant & upwards.

2、Replace fill valve

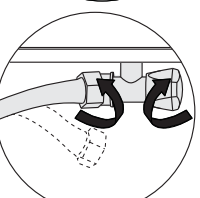
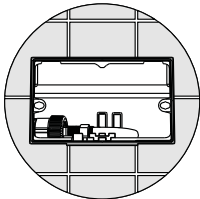

Close the stop valve, loosen and remove the flexible connection pipe.

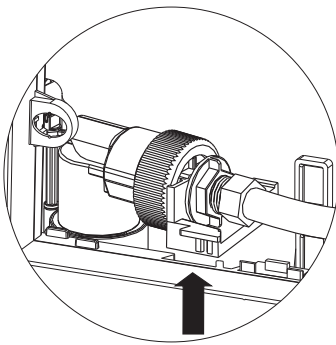

Pull out the valve from the coupling.

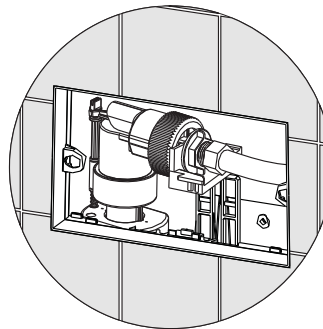

Pull up the fill valve at an angel.

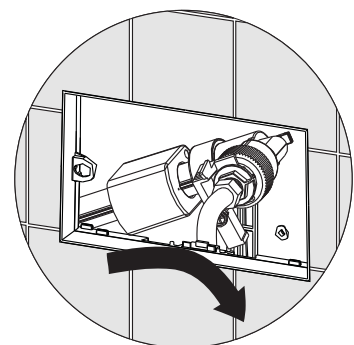

Take out the fill valve aslant.

3、Replace flush valve

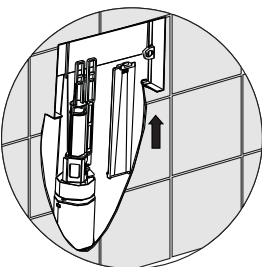

Pull the flush valve with left hand lightly, with the right hand holding the flush frame top and pull it out.

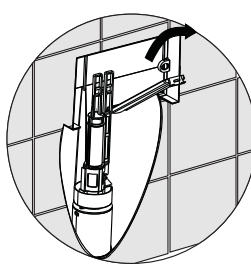

Move the flush frame to the right and take it out.

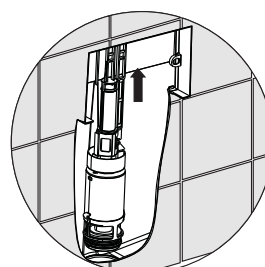

Pull the flush valve upwards slightly

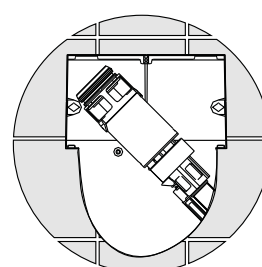

Turna the flush upside down

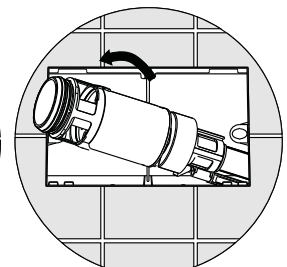

Take out the flush valve at an angel

Technologic data:

- 1/2" standard fill water hole.
- The water stress range of fill water it 0.02~1.0Mpa. 0.2 - 4 bar
- The water temperature range is 2~45℃.
- 3L/6L dual flush water volume, the flush water time is 3s~5s.
- The product can be installed in the wall of 78mm thickness.

1、Maintenance of fill valve

Troubleshooting

malfunction	solve way
1.The water level too high or too low	Adjust the water level
2.Can not stop water	Wash the rubber and seal and filter
3.Fill water speed slow	Wash filter, increase the water pressure
4.Others questions	Plases consult with a professional technician

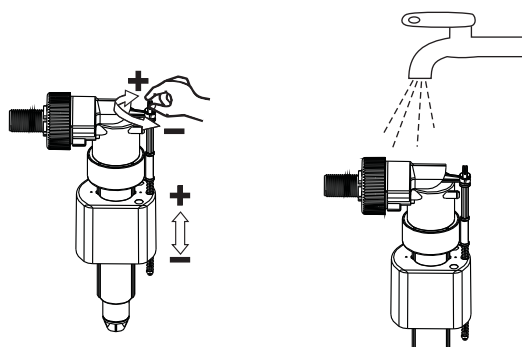

①Turn the knob,adjust water level height.

②Wash the dirt

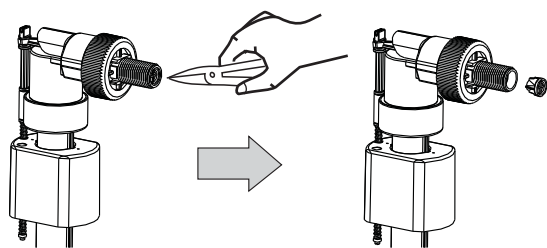

□Take off the filter tip and clean

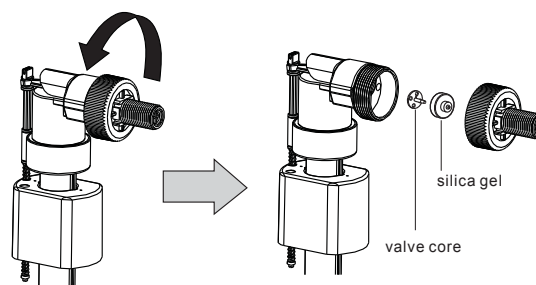

□Loosen the nut and clean or replace the valve core and the silica gel of fill valve

2、Maintenance for flush valve

Troubleshooting

malfunction	reason	solve way
1.Can not flush water	The flush pole may be damaged	Replace the flush pole
	The working water level too low	Adjust the working water level
1.Leaking	The rubber seal can not seal water	Replace the rubber seal
	The movement of flush valve is blocked	Wash the debris of flush valve

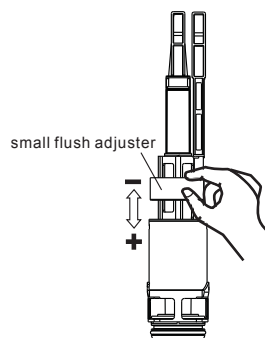

①Adjust the small flush water volume by adjust the small flush adjuster.

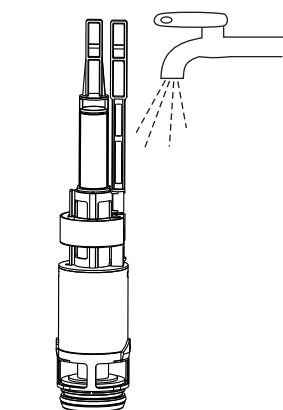

②Wash the debris out by flushing and clean water.

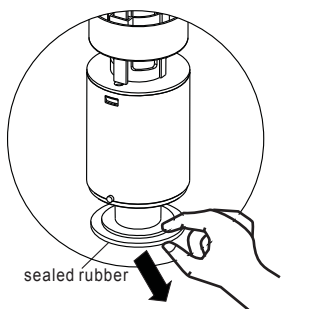

③Take out of the silica gel of flush valve, clean or replace it.

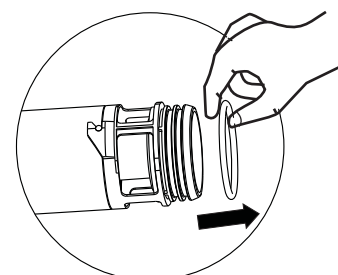

④Take out of the sealed rubber of flush valve, clean or replace it.